

Cumberland  
County

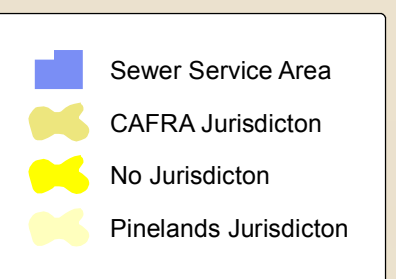

Cape May County

Facility Name	NUPERS
Alpine Village - Alpine County	N005107
L's Restaurant	N005167
Summit - Marin County	N005168
Greenleafs Golf Course	N005180
Marin	N005181
Estel Manor - Alameda County Park	N005182
The Faraway Restaurant	N005188
Richmond	N005197
Gateway National Golf Club - Contra Costa	N005988
Chesapeake	N005990
Hickory Haven Campground LLC	N005998
Low Meadows Campground	N005998
Yogi Bares Athletic Park	N005998
Pleasanton	N005998
Chesapeake	N005998
Chesapeake	N005998
Alpine Village Mobile Home Court	N005107
Richmond	N005241
Winning Horse Campground	N005184
Palmdale	N005184
Palmyra Assembly	N005184
Holly Ranch Mobile Home Park	N005192
Mulica Woods Holiday Travel Park	N005192
Burns Family Manor	N005192
Indian Meadows Campground	N005192
Scholar, Inc.	N005274
Palmdale	N005274
Liberty Square Entertainment LLC	N005194
Palmdale	N005194
Smithville Professional Center	N007387
New River	N007387
Colonial Meadows Family Campground	N005988
Egg Harbor River	N005984
Oakdale Mobile Home Park	N005984
Blueberry Hill Campground	N005984
Q&E	N005984
County Parks	N005988
Hayward Elementary School plan	N005988
Edwood School	N005984
Edwood Elementary School	N005984
Edwood Elementary School	N005984
Mornings at Sweetwater	N007032
Red Bluff	N007032
South Jersey Sea Camp	N005984
South Jersey Sea Camp	N005984
Swampscott	N005984
Swampscott	N005984
Willetts Glass Co	N007400

- GS Parkway
- Municipal Roads
- AC Expressway
- US & State Highway
- County Routes

Surface waters that are designated Category One are listed in the Surface Water Quality Standards at N.J.A.C. 7:9B. The Department's "Surface Water Quality Standards" GIS was utilized to determine these waters. The applicable 300 foot buffer has been applied to these waterways and removed from the proposed sewer service areas on the mapping. width buffers have not been graphically removed from the sewer service area but are not proposed for sewer service. [Counties may map out the lesser with buffers also but the 300 buffers are the minimum, the lesser buffers are removed during the build-out analysis.] Jurisdictional determinations by the Department will be utilized to determine the extent of the sewer service area on individual lots.

\*Pre-existing grant conditions and requirements (from Federal and State grants or loans for sewerage facilities) which provide for restriction of sewer service to environmentally sensitive areas, are unaffected by adoption of this WMP and compliance is required. Please see municipal WMP Chapters for the existence of any applicable environmentally sensitive areas in which Federal 201 grant limitations prohibit the extension of sewer service\*.

\* Areas located within the watershed of a Freshwater One (FW1) stream, as classified in the Surface Water Quality Standards, and/or that have Class 1-A ground water (Ground Water Quality Standard 1-A), as classified in the Ground Water Quality Standards, are identified as "Non-degradation water area based on the Surface Water Quality Standard 1-A, N.J.A.C. 7:9-B, and/or the Ground Water Quality Standards at N.J.A.C. 7:9-5.7." Where this requirement has been studied and reviewed as part of the WMP process this classification is noted.

\*Proposed developments lying in existing and proposed sewer service areas which require coastal permits must demonstrate compliance with all applicable sections of the Coastal Zone Management Act, 16 U.S.C. 1601 et seq., and the implementing regulations, 36 C.F.R. 12.1 et seq. and 36 C.F.R. 122.1 et seq. The following are the minimum standards for proposed developments in existing and proposed sewer service areas which require coastal permits:

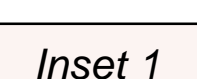

ATLANTIC CITY

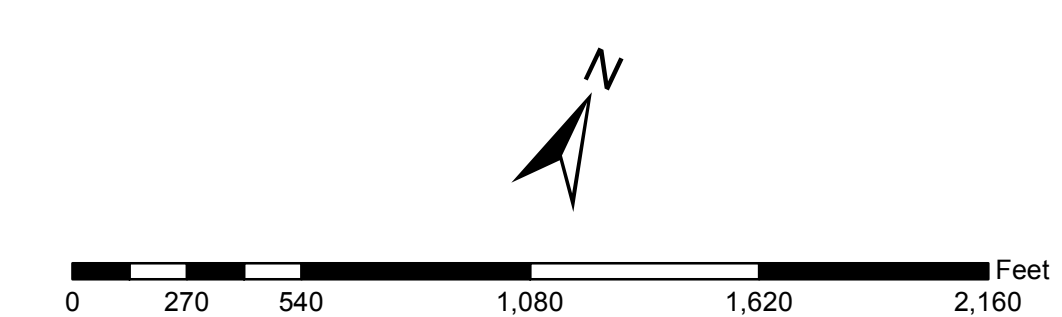

This map is for demonstration purposes only and was not developed in accordance with National Map Accuracy Standards. Any use of this product with respect to accuracy and precision shall be the sole responsibility of the user. The map was developed, in part, using New Jersey Department of Environmental Protection Geographic Information Systems data. The data was obtained from the Atlantic County Office of Geographic Information Systems, but this secondary product has not been verified by NJDEP and is not state authorized. The geographic accuracy and precision of the data contained in this map has not been independently verified by a professional licensed land surveyor and shall not be used or intended to be used in matters requiring delineation and location of ground horizontal and/or vertical controls.

File:AtlanticCounty\_SNA\_10613\_A\_TC.mxd printed on: 10/16/2015